

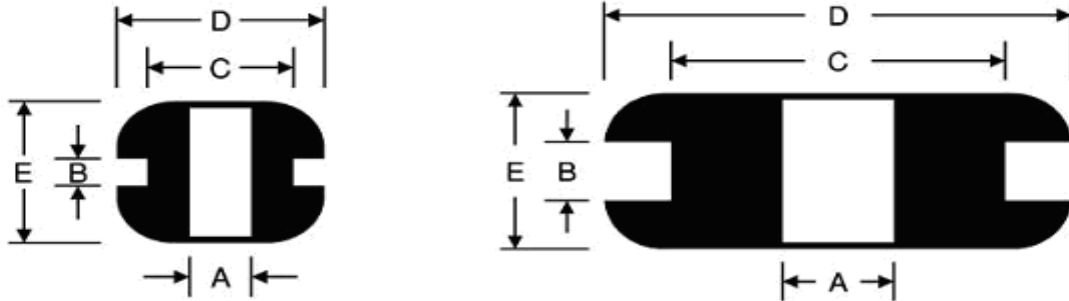

## GROMMETS



Part ID	Grommet Dimensions*				
	A	B	C	D	E
GR - 01	1/8	1/32	3/16	1/4	3/32
GR - 02	3/16	1/32	5/16	7/16	7/32
GR - 03	3/16	1/8	9/16	3/4	1/4
GR - 04	1/4	1/16	3/8	1/2	1/4
GR - 05	1/4	1/4	7/16	5/8	3/8
GR - 06	9/32	1/4	15/32	11/16	7/16
GR - 07	5/16	1/16	7/16	5/8	9/32
GR - 08	5/16	3/16	3/4	1	7/16
GR - 09	3/8	1/16	1/2	5/8	1/4
GR - 10	3/8	1/4	5/8	7/8	1/2
GR - 11	7/16	1/4	11/16	15/16	1/2
GR - 12	1/2	1/16	13/16	1-1/16	5/16
GR - 13	9/16	1/16	13/16	1-1/16	3/8
GR - 14	5/8	1/16	13/16	1-1/16	5/16
GR - 15	5/8	1/4	7/8	1-1/8	1/2
GR - 16	3/4	1/16	1-1/16	1-3/8	3/8
GR - 17	7/8	1/16	1-1/4	1-5/8	7/16
GR - 18	1	1/16	1-3/8	1-3/4	7/16
GR - 19	1-1/8	1/16	1-1/2	1-7/8	3/8
GR - 20	1-1/2	1/16	1-1/2	2-1/8	7/16
GR - 21	1-1/2	1/8	1-3/4	2-1/8	1/2
GR - 22	1-1/2	3/16	1-3/4	2-1/8	9/16
GR - 23	2-1/8	1/16	2-1/2	2-7/8	7/16
GR - 24	2-1/8	1/8	2-1/2	2-7/8	1/2

\* We can manufacture Grommets in sizes other than those indicated above.